

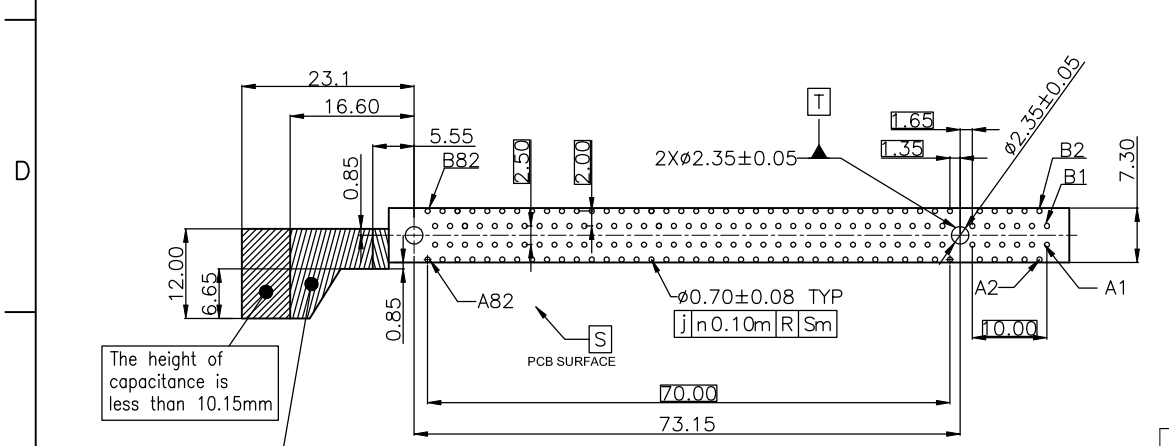

REV.	ECN NO.	LOCATION	DESCRIPTION	DATE	DESIGN
X1			INITIAL RELEASE	2020.10.23	Chen
X3			UPDATE PACKAGE SPEC	2022.3.2	Cy.Zhu

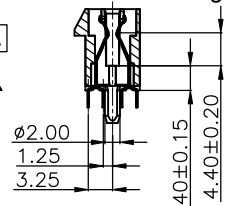
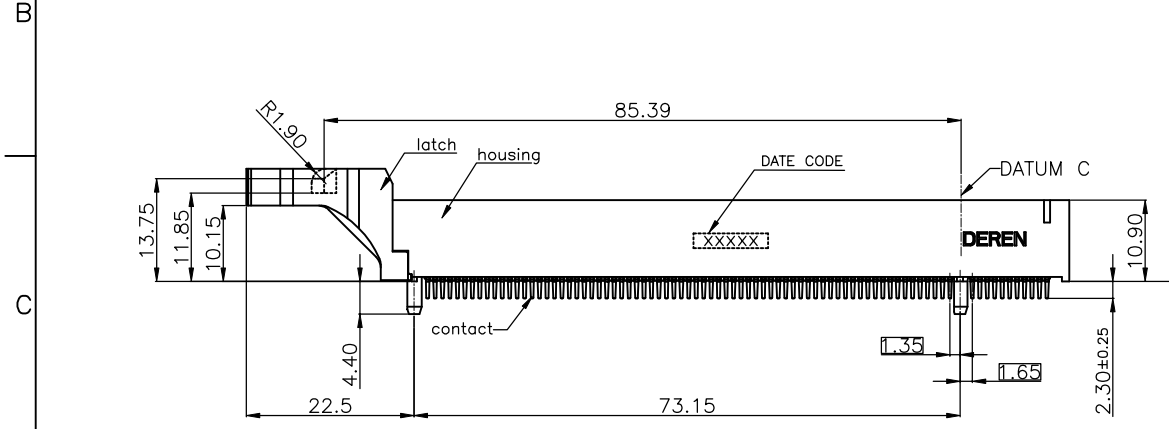
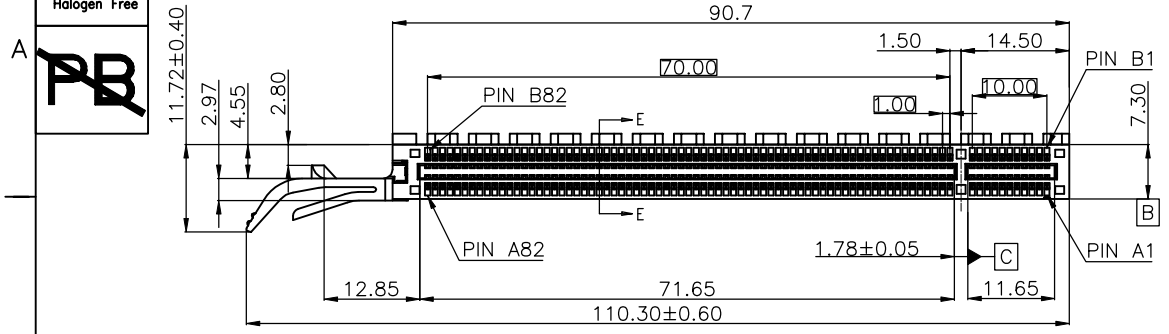

The height of capacitance is less than 10.15mm

The height of capacitance is less than 3.52mm

NOTES:
 PRODUCT MEETS CONTROLLED SUBSTANCES SPEC. ROHS 2.0
 1. MATERIAL:
 1.1 HOUSING:POLYMER PLASTIC, UL94V-0; COLOR: BLACK
 1.2 CONTACT COPPER ALLOY
 1.3 LATCH:POLYMER PLASTIC, UL94V-0; COLOR: BLACK
 2. FINISH:
 CONTACT:GOLD PLATING(SEE PART NUMBER) ON CONTACT AREA.
 2.0um[80u"] MIN. MATTE-TIN PLATING ON SOLDER TAIL AREA.
 1.27um[50u"] MIN. NICKEL UNDERPLATING OVER ALL.
 3.DATE CODE : YYWW (YY: YEAR, WW: WEEK, D: DAY)
 4.PART NUMBER DESCRIPTION:
 564ZD4 - 002H * * * * *

PACKING CODE: 1:TRAY
 2:REEL
 HOUSING COLOR: 1:BLACK 2:WITHE 3.BLUE
 TAIL LENGTH CODE:1:2.3mm 2.3.1mm
 3.1.80mm 4.3.56mm

RIDGE&POS CODE:
 1.HOUSING POST&WITH RIDGE
 2.HOUSING POST&WITHOUT RIDGE
 3.BOARD LOOK&WITH RIDGE
 4.BOARD LOOK&WITHOUT RIDGE

PLATING CODE: 1: G/F
 2: 15u" Min
 3: 30u" Min

HALOGEN CODE: H: HALOGEN FREE

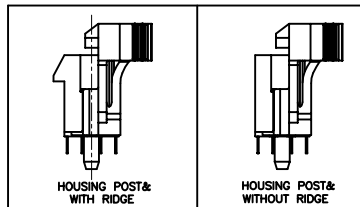

I/O PANEL DIRECTION →

RECOMMENDED PCB LAYOUT

DIM	TOL	DIM	TOL
x.	±0.30	x.	±2°
.x	±0.25	.x	±1°
.xx	±0.20		

DEREN
 SHENZHEN DEREN ELECTRONIC CO., LTD

CUSTOMER DRAWING: SC20---
 DATE: 2022.3.2

DESIGN: Cy.Zhu
 CHECK: Mick.Chen
 APPROVAL: Bill.Lin

DATE: 2022.3.2

PCI EXPRESS DIP TYPE WITH LATCH 164PIN
 P/N: SEE TABLE
 SHEET: 1/3
 SCALE: 1:1 UNIT: mm

HF
Halogen Free

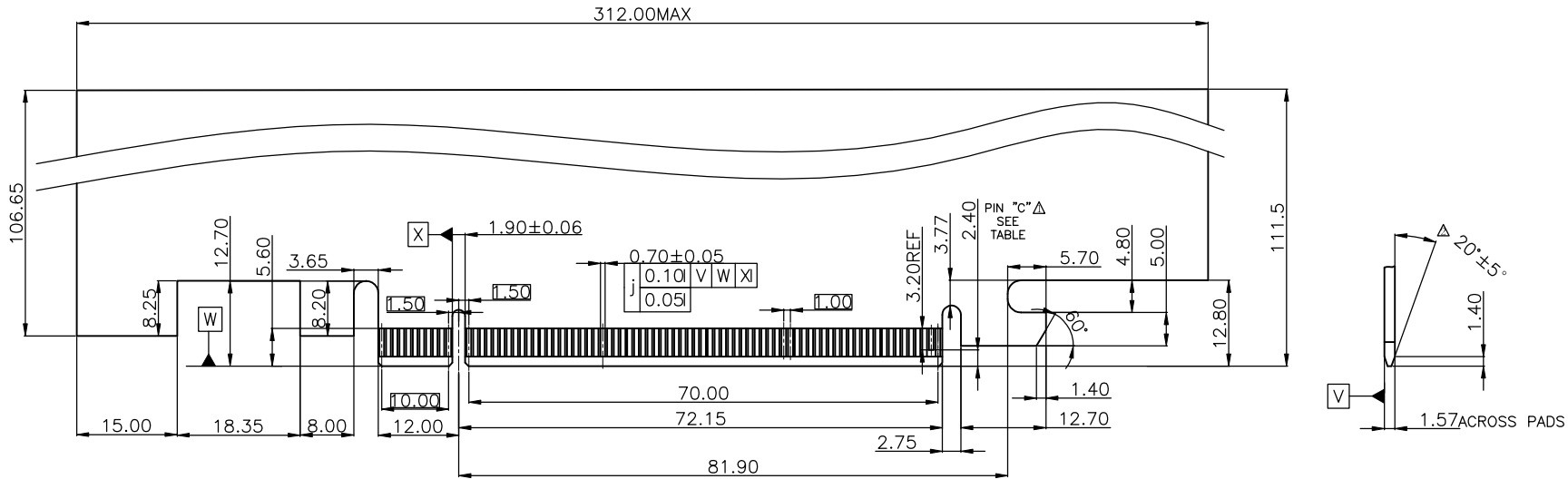

← I/O PANEL DIRECTION
PRIMARY (COMPONENT) SIDE

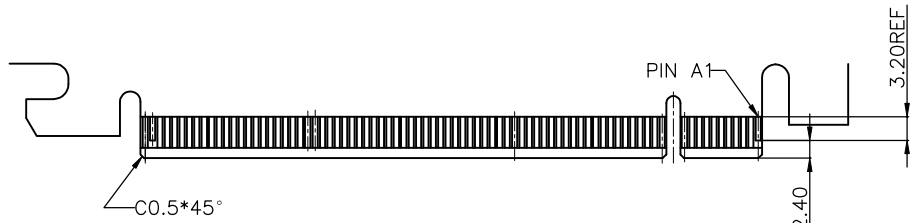
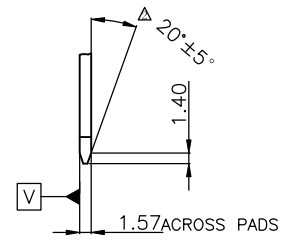

I/O PANEL DIRECTION →
PRIMARY (COMPONENT) SIDE
Add-in Card Edge-Finger Dimensions

- NOTES:**
- △ NO TIE BAR PERMITTED FROM CARD EDGE TO LEADING EDGE OF PAD FOR PINS A1 AND "C"
 - △ CHAMFER EDGES MUST BE FREE OF CUTTING BURRS TOLERANCE UNLESS OTHERWISE NOTED IS ±0.13
- 1.ELECTRICAL CHARACTERISTICS :**
- 1-1.CURRENT RATING:1.1AMP.30°C RISE ABOVE AMBIENT.
 - 1-2.CONTACT RESISTANCE:30 MILLIOHMS MAX. INITIAL, 50 MILLIOHMS MAX. AFTER TEST.
 - 1-3.INSULATION RESISTANCE:1000 MEGOHMS MIN.
 - 1-4.DIELECTRICAL WITHSTAND VOLTAGE:500V AC MIN.AT SEA LEVEL.
- 2.MECHANICAL CHARACTERISTICS:**
- 2-1.CARD INSERTION FORCE:117gf MAX.PER CONTACT PAIR.
 - 2-2.DURABILITY:50 MATING AND UNMATING CYCLES.
 - 2-3.CARD REMOVAL FORCE:15gf MIN.PER CONTACT PAIR.
 - 2-4.CONTACT RETENTION FORCE:200gf MIN.
- 3.ENVIRONMENTAL CHARACTERISTICS:**
- 3-1.OPERATING TEMPERATURE RANGE:-40°C TO +105°C.

DIM	TOL	DIM	TOL
x.	±0.30	x.	±2°
.x	±0.25	.x	±1°
.xx	±0.20		



DEREN			
SHENZHEN DEREN ELECTRONIC CO., LTD			
CUSTOMER	DRAWING	DATE	TITLE: PCI EXPRESS DIP TYPE WITH LATCH 164PIN
DESIGN:	Cy.Zhu	2022.3.2	
CHECK:	Mick.Chen	2022.3.2	
REV.	X3	APPROVAL:	Bill.Lin 2022.3.2
P/N: SEE TABLE		SHEET: 2/3	UNIT: mm
SCALE: 1:1			

HF
Halogen Free

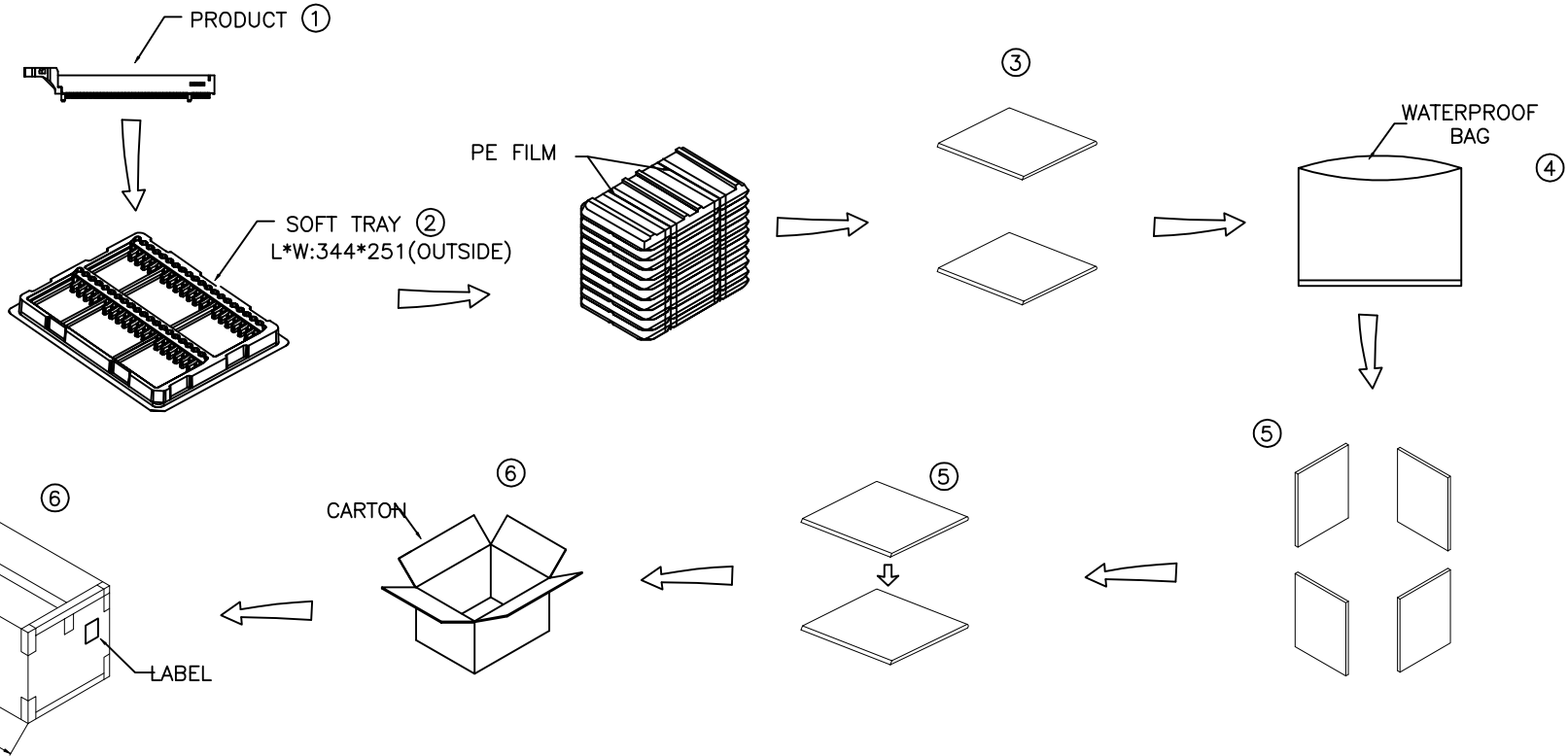

NOTE:

1. PUT THE PRODUCTS INTO TRAY WITH DIRECTION AS THE LEFT SKETCH SHOWN, Q'TY SEE TABLE, 8 TRAYS STACKED UP PER BUNDLE. THEN ADD ONE EMPTY TRAY ON TOPSIDE .
2. WIND THE TWO ENDS WITH PE FILM.
3. PUT THE PRODUCTS BUNDLED INTO WATER-PROOF PE BAG, 1BUNDLES/BAG, THEN PUT INTO THE CARTON.
4. SEAL OUTER CARTON WITH PACKING TAPE LIKE A 'H' SHAPE
5. PACKAGING QUANTITY: 320PCS/CARTON.

6	CARTON			1
5	PE FORM	730101-034H	L330*W230 T=10	6
4	BAG	55-41009-01	750*600*0.05mm	1
3	CARD BOARD	52-40002-01	380*380*3mm	2
2	SOFT TRAY	-	344*251mm	8
1	CONN	-	-	280pcs
NO.	PART NAME	PART NUMBER	SPEC.	QTY

DIM	TOL	DIM	TOL
x.		x.	
.x		.x	
.xx			

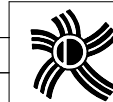

DEREN

SHENZHEN DEREN ELECTRONIC CO., LTD

DRAW NO. SC20----	DESIGN:	Cy.Zhu	DATE	2022.3.2
	CHECK:	Mick.Chen	DATE	2022.3.2
	REV.	X3	APPROVAL:	Bill.Lin 2022.3.2
	TITLE: PCI EXPRESS DIP TYPE WITH LATCH 16PIN			
P/N: SEE TABLE				
SHEET: 3/3		SCALE: 1:1 UNIT: mm		